



**INCON**



Threaded  
(ITS - Standard Coupler)

## ITS – Standard Coupler

### **INSTALLATION:**

1- Upset and thread the end of the reinforcing bars using INCON's forging and threading machine.

2- Screw the ITS Coupler by rotating it clockwise on the threads of one of the reinforcing bars.

3- Align the second bar and screw it inside the coupler until the connection is completely secured.

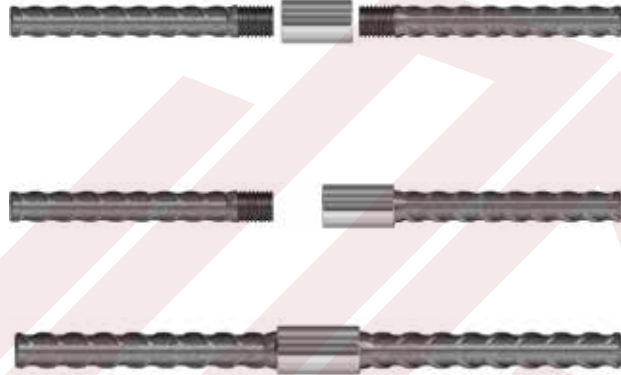

### **CONFIGURATION:**

ITS Coupler is composed of an internally threaded steel tube that connects two threaded bars of the same size and identical threaded length.

### **MAIN APPLICATION:**

ITS Coupler is widely used for general construction applications where the rotation and axial movement of at least one bar is allowed.

### **FEATURES:**

- Applicable for high strength reinforcing bars up to ASTM Grade 60.
- Conforms to the latest version of IBC, ACI 318, CSA A23.3, BS 8110, NF 35-20 and DIN 1045.
- Easily installed and highly efficient for preparing the mechanical splice on site.
- Highly reliable and consistent performance owing to our strict quality control program.
- Compact design to reduce reinforcement congestion at connections.

### **AVAILABLE MATERIALS AND COATINGS:**

- **Uncoated Steel:** used with uncoated steel bars in typical construction applications.
- **Galvanized Steel:** used with galvanized steel bars and for other special applications.
- **Stainless Steel:** used with stainless steel bars and for other special applications.
- **Epoxy Coated Steel:** used with epoxy coated steel bars and for other special applications.

# ITS – Standard Coupler

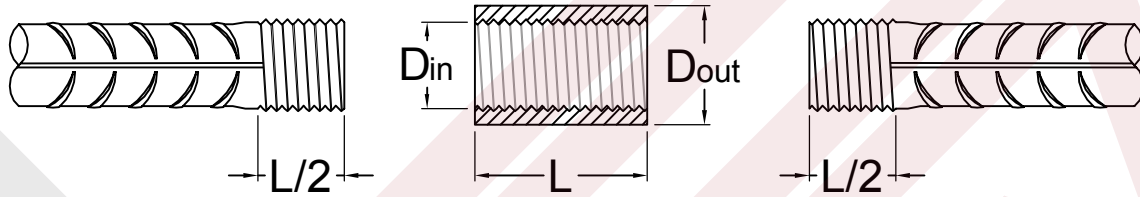

CANADA	Coupler Code	Bar Size	Outer Diameter	Inner Diameter	Thread Size	Coupler Length	Thread Length of the Bar
			D <sub>out</sub> (mm)	D <sub>in</sub> (mm)	M x p (mm x mm)	L (mm)	L/2 (mm)
	ITS10M	10M	20.0	14.0	M14x2.0	28.0	14.0
	ITS15M	15M	27.0	20.0	M20x2.5	40.0	20.0
	ITS20M	20M	33.0	24.0	M24x3.0	48.0	24.0
	ITS25M	25M	41.0	30.0	M30x3.5	60.0	30.0
	ITS30M	30M	48.0	36.0	M36x4.0	72.0	36.0
	ITS35M	35M	55.0	39.0	M39x3.0	78.0	39.0
	ITS45M	45M	66.0	48.0	M48x5.0	96.0	48.0

USA	Coupler Code	Bar Size	Outer Diameter	Inner Diameter	Thread Size	Coupler Length	Thread Length of the Bar
			D <sub>out</sub> (in)	D <sub>in</sub> (mm)	M x TPI (in)	L (in)	L/2 (mm)
	ITS#4	#4	0.83	0.63	0.63x12.7	1.26	0.63
	ITS#5	#5	1.06	0.79	0.79x10.2	1.57	0.79
	ITS#6	#6	1.30	0.94	0.94x8.5	1.89	0.94
	ITS#7	#7	1.46	1.06	1.06x12.7	2.13	1.06
	ITS#8	#8	1.61	1.18	1.18x7.3	2.36	1.18
	ITS#9	#9	1.81	1.30	1.30x7.3	2.60	1.30
	ITS#10	#10	2.01	1.42	1.42x6.4	2.83	1.42
	ITS#11	#11	2.17	1.54	1.54x8.5	3.07	1.54
	ITS#14	#14	2.56	1.89	1.89x5.1	3.78	1.89

EUROPE & MIDDLE EAST	Coupler Code	Bar Size	Outer Diameter	Inner Diameter	Thread Size	Coupler Length	Thread Length of the Bar
			D <sub>out</sub> (mm)	D <sub>in</sub> (mm)	M x p (mm x mm)	L (mm)	L/2 (mm)
	ITS12	12	20.0	14.0	M14x2.0	28.0	14.0
	ITS16	16	27.0	20.0	M20x2.5	40.0	20.0
	ITS20	20	33.0	24.0	M24x3.0	48.0	24.0
	ITS25	25	41.0	30.0	M30x3.5	60.0	30.0
	ITS32	32	51.0	36.0	M36x4.0	72.0	36.0
	ITS40	40	64.0	45.0	M45x4.5	90.0	45.0

Dimensions are subject to change without prior notice.



**INCON**



CANADA: +1 519 657 2510  
EMAIL: INFO@INCON.CA



[WWW.INCON.CA](http://WWW.INCON.CA)